

Goblin

Scoot cylinder vacuum cleaner

Please read and keep these instructions

UK
Helpline 0870 060 2604
Replacement parts 0870 167 6635
Ireland
1800 409119

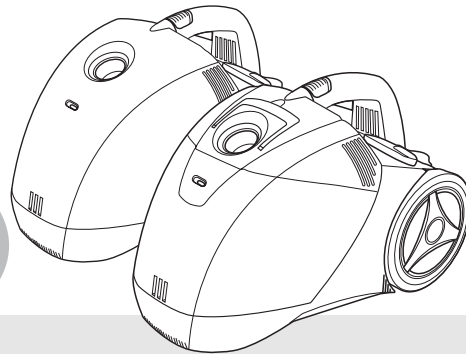

getting the best from
your new cleaner...

If your cleaner isn't picking up as well as it should, please check

- **Reusable dustbags**

It is important to empty them regularly, otherwise the performance of the cleaner will be impaired. They should regularly washed in warm water and left to air dry

- **Disposable paper dustbags**

It is important to replace them regularly, otherwise the performance of the cleaner will be impaired

- **Filters**

It is important that the filters are cleaned regularly or replaced to allow air through the appliance

- **Blockages**

Check the nozzle, tubes and hose for blockages



www.morphyrichards.co.uk

Important safety instructions

The use of any electrical appliance requires the following of common sense safety rules.

Primarily there is danger of personal injury and secondly danger of damage to the appliance and property. These are indicated in the text by the following two conventions:

WARNING: Danger of personal injury

IMPORTANT: Damage to the appliance

In addition we offer the following essential safety advice.

Location

- Do not use or keep this product outside when it is raining.
- Do not store the appliance near hot ovens or heating appliances.

Mains lead

- Do not allow the mains lead to become strained or run this appliance over it.
- If the electrical cable becomes damaged the complete cable assembly must be replaced. Do not attempt this task yourself, contact Goblin using the helpline number.

Children

- Children do not understand the dangers associated with operating electrical appliances. Never allow children to use this appliance.

Other safety considerations

- Never use the appliance without the filter installed.
- Never use the appliance to vacuum hot ashes, broken glass, sharp objects or liquids.
- Never use in the presence of explosive liquids or vapours.
- Never pick up inflammable or poisonous liquids such as petrol, copier toner, or other volatile substances. Never pick up acids, asbestos or asbestos dust.

- Always disconnect the appliance from the mains supply after use or prior to cleaning or replacing dust bags.
- The appliance should never be left running unsupervised.
- Never modify the cleaner in any way.
- Repairs to electrical appliances are only to be undertaken by trained personnel. Unprofessional repairs can be dangerous for users.
- Use only genuine Goblin spare parts and accessories.

Electrical requirements

Check that the voltage on the rating plate of your appliance corresponds with your house electricity supply which must be A.C. (Alternating Current).

If the socket outlets in your home are not suitable for the plug supplied with this appliance, the plug should be removed and the appropriate one fitted.

If you cut off the plug and let go of the cable it will rewind into the machine therefore, you must pull out a length of cable and secure it before cutting off the plug and fitting a new one.

WARNING: The plug removed from the mains lead, if severed, must be destroyed as a plug with bared flexible cord is hazardous if engaged into a live socket outlet.

Should the fuse in the 13 amp plug require replacement, a BS1362 13 amp fuse must be fitted.

Features

- | | |
|---------------------------------|--|
| 1 Hose inlet | 9 Crevice tool |
| 2 Lid release | 10 Upholstery nozzle |
| 3 Carrying handle | 11 Flexible hose |
| 4 Dustbag indicator | 12 Hose end |
| 5 Handle on cover (type B only) | 13 Hose handle |
| 6 Stair lock bracket | 14 Handle suction control |
| 7 On/off button | 15 Floor nozzle (one of two different types) |
| 8 Cable rewind button | 16 2 x extension tubes or |
| | 17 1 x adjustable length tube |

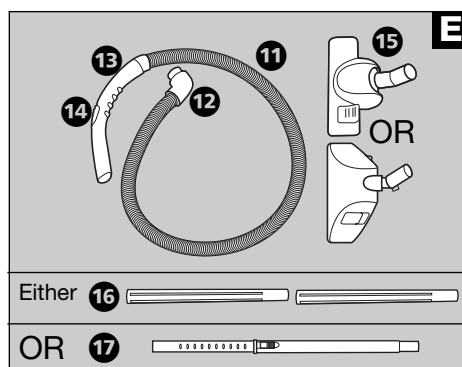
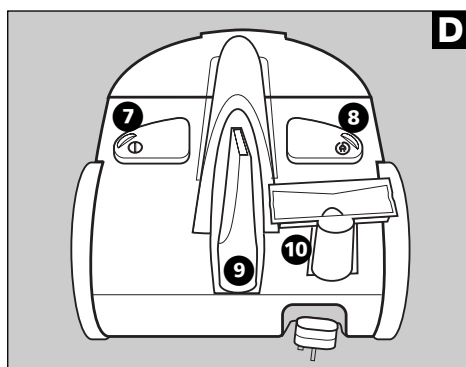
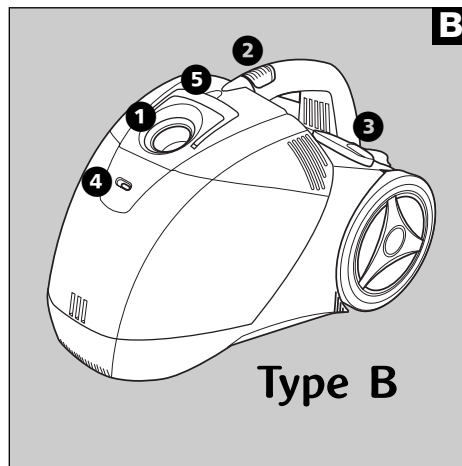
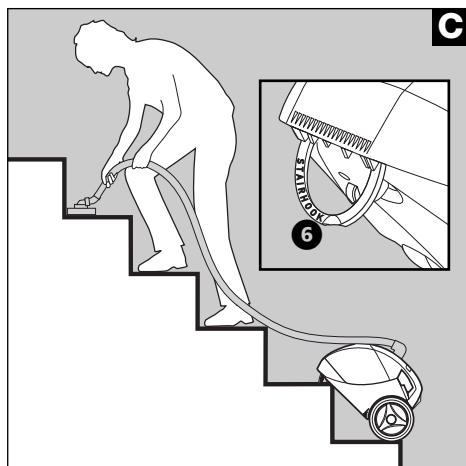
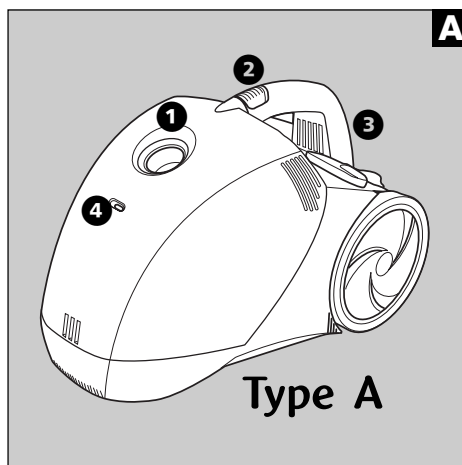

Assembly

Hose 12

- 1 Insert the hose end 12 into the hose inlet until it clips securely into position.

Extension tubes 16

- 1 Join the two tubes together.
- 2 Attach the extension tubes to the handle of the hose.

Or if the cleaner features an adjustable length tube 17

- 1 Press the release button on the tube and extend the tubes to the required length F.
- 2 Attach the extension tube to the handle of the hose.

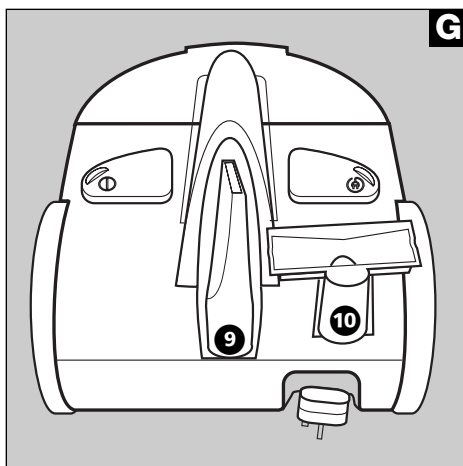
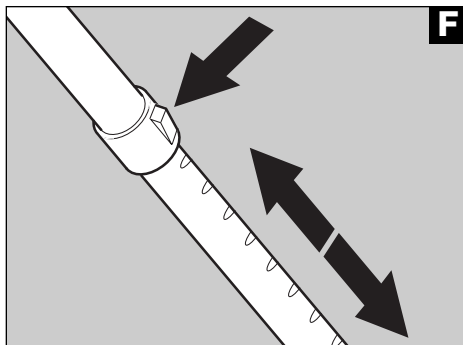

4

Floor nozzle 15

The floor nozzle may vary according to model type.

Fit the floor nozzle onto the end of the extension tube.

If the nozzle features an adjustment pedal, the brushes should be retracted for use on carpets/rugs and out for hard floors.

Upholstery nozzle 10

Recommended applications include stairs, upholstery, mattresses and curtains.

Crevice tool 9

Recommended applications include joints, folds and corners.

These accessories can either be fitted onto the extension tube or directly onto the handle, depending on cleaning task.

The upholstery nozzle and crevice tool can be stored on the back of the cleaner G.

Operation

- 1** IMPORTANT: Your cleaner features automatic cable rewind **8**, ensure the full length of cable is pulled out.
- 2** Plug into the electrical socket.
- 3** Switch the cleaner on using the on/off button **7**.

Controlling suction power

Suction power can be adjusted using the handle suction control **4**. Keep it closed for full suction and open for reduced suction.

Stair lock **6**

This unique system assists with stair cleaning. The stairhook **6**, found underneath, is lifted out as shown **1** and locked onto the stairs. In addition, the rear wheels automatically lock in position as further security.

After use, simply push the stairhook firmly back into position.

IMPORTANT: When cleaning on stairs, for convenience and safety, work from the bottom to the top with the desired accessory connected directly onto the hose handle. *It is recommended not to use extension tubes.*

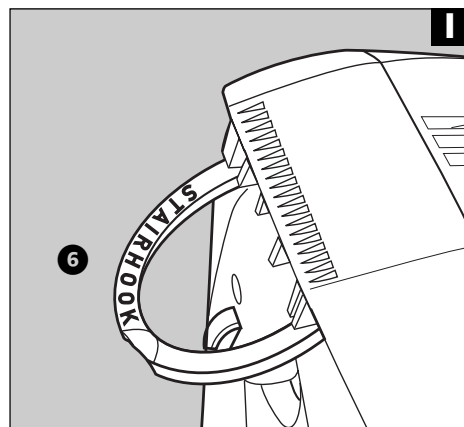
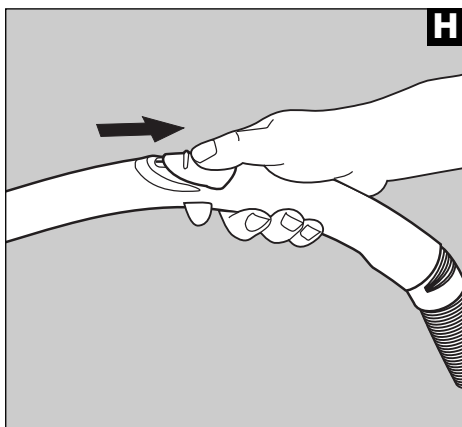

Replacing/Emptying bags

The Scoot is supplied with a reusable washable dustbag. Should you wish to use disposable paper bags, these can be obtained by telephoning our replacement parts line 0870 167 6635.

To obtain best results from your cleaner the dustbag needs to be emptied regularly otherwise the airflow and cleaning power will be reduced. When the dustbag indicator **4** shows fully red and performance deteriorates, first check if there are any blockages in the accessories or tubes. If these are clear, it is necessary to empty the dustbag (or replace if using paper bags).

IMPORTANT: The method for replacing the bag varies according to the model type. Please refer to the diagram on page 3.

Diagram **A** = Type A

Diagram **B** = Type B

Type **A** reusable bag

- 1 Remove the hose end from the hose inlet by squeezing clips on either side **J**.
- 2 Slide the lid release **2**, lift and remove the cover **K**.
- 3 Holding the cover over a bin, pull securing tab **L** to release the bag. However do not allow the bag to fall into the bin.
- 4 Holding the dustbag over the bin, slide the clip from the bottom of the bag and tip the contents of the bag carefully into the bin **O**. Shake the bag vigorously to

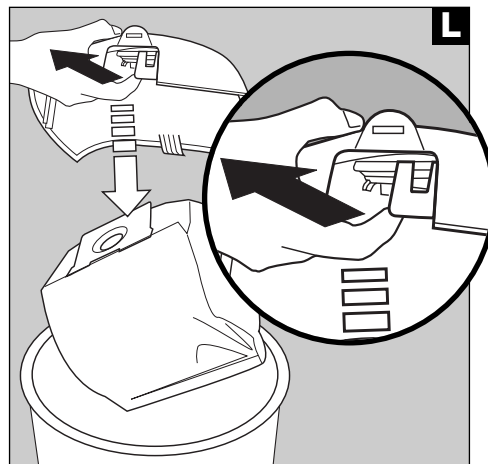
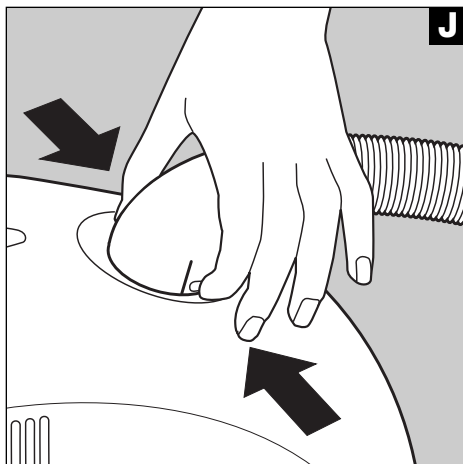
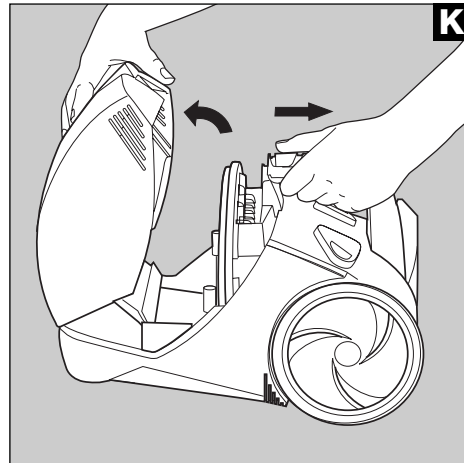

remove excess dust.

- 5 Slide the clip back onto the bottom of the dustbag and replace the dustbag into position.

- 6 Relocate the lid at the front first and then close the cover securely **N**.

To maintain performance we recommend that the reusable bag is hand washed regularly in warm water. Do not use detergents as these could affect performance. Allow to dry naturally as direct heat may effect the material.

IMPORTANT: Ensure the dustbag is totally dry before refitting it into the cleaner.

Type **A** disposable paper bag

Follow steps 1, 2, 3 as above, allowing the bag to fall in the bin.

- 4 Insert the new paper dustbag ensuring that the bag collar is held in place by the securing tab **M**.

- 5 Relocate the lid at the front first and then close the cover securely **N**.

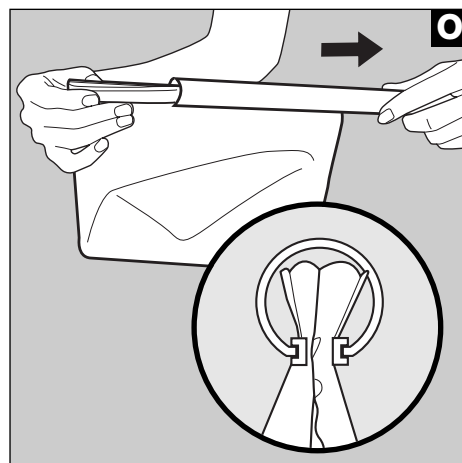
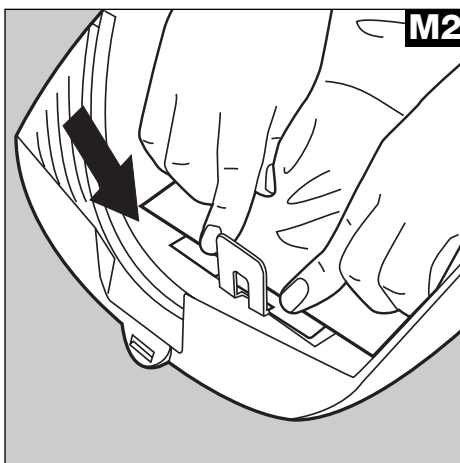
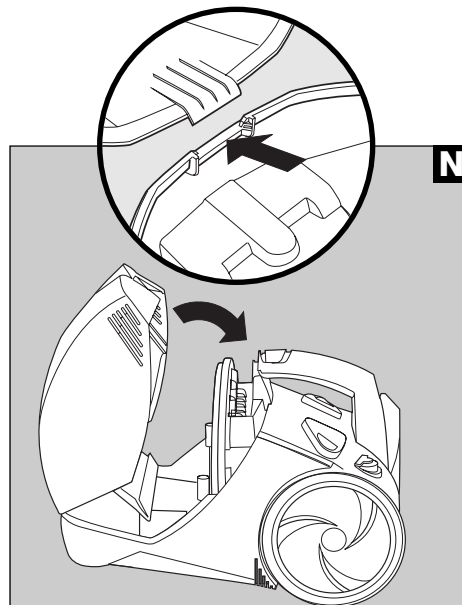
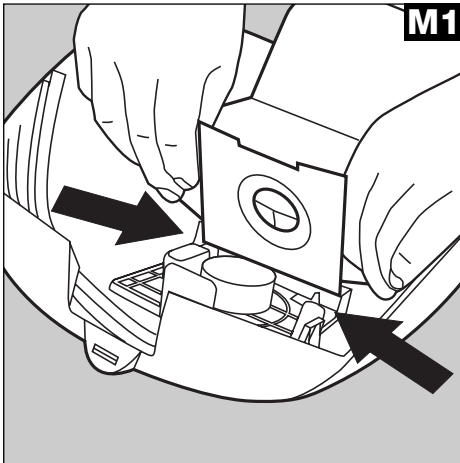

Type **Q** reusable bag

- 1 Remove the hose end from the hose inlet **J**.
- 2 Raise the handle **5** on cover.
- 3 Slide the lid release **2** and lift off the cover with the bag attached.
- 4 Take the cover and dust bag to the bin. Beneath the handle **5** there is a clip **P**. Push this forward to release the bag. The bag will slide out of its holder.
- 5 Holding the dustbag over the bin, slide the clip from the bottom of the bag and tip the contents of the bag carefully into the bin **O**. Shake the bag vigorously to remove excess dust.
- 6 Slide the clip back onto the bottom of the dustbag.
- 7 Refit the bag by sliding it into its holder **Q1** then closing the holder onto the inlet tube **Q2** making sure that the holder clip is secured beneath the handle.
- 8 Relocate the lid at the front first and then close the cover securely **N**.

Type **Q** disposable paper bag

- Follow steps 1, 2, 3 and 4 as above but allow the bag to fall into the bin.
- 5 Refit the bag by sliding it into its holder **Q1** then closing the holder onto the inlet tube **Q2** making sure that the holder clip is secured beneath the handle.
 - 6 Relocate the lid at the front first and then close the cover securely **N**.

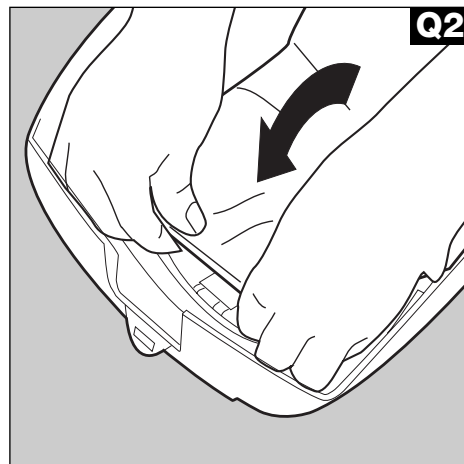
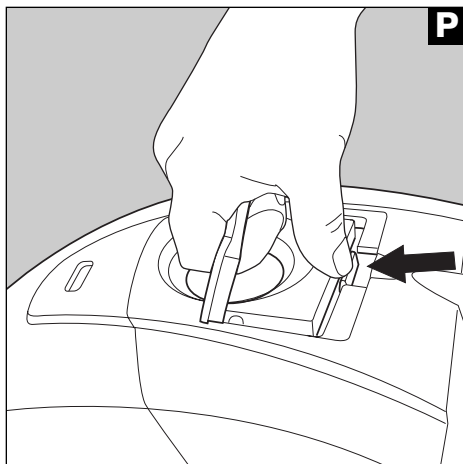
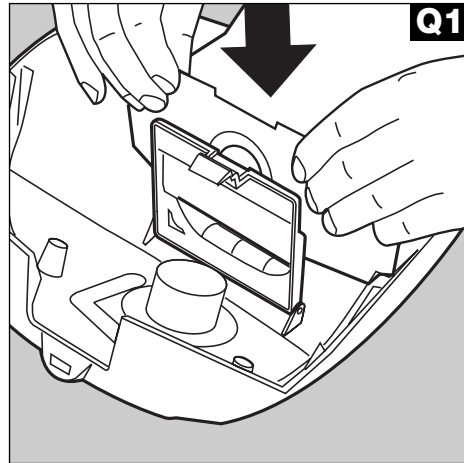

Cleaning and replacing filters

The cleaner has a highly effective filtration system, ensuring that the exhaust air is as clean as possible **R**. To maintain this, both motor protection filter **18** and exhaust filter **19** need to be cleaned and replaced at regular intervals.

We recommend cleaning the filters every time the dust bag is emptied and replacing the filter every 6 months. To remove the filters simply slide them out of their location.

IMPORTANT: Never use the appliance without the motor protection and exhaust filter installed, otherwise damage to the product may occur which would not be covered by the guarantee.

Purchasing replacement bags and filters

Use only Goblin replacement bags and filters which can be purchased from specialist retailers or by calling the replacement parts telephone line.

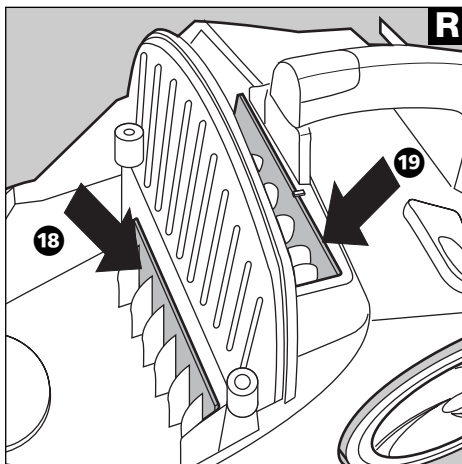

Storage and maintenance

Unplug cleaner from mains before cleaning.

Press the cord rewind button **8**, to rewind the cord into the storage unit.

The vacuum cleaner and all the accessories can be cleaned using a damp cloth and wiped dry.

To keep the underside of the floor nozzle clean, vacuum it at regular intervals using the crevice tool.

Helpline

If you have any difficulty with your appliance, do not hesitate to call our helpline. We're more likely able to help than the store from where you bought it.

Please have the following information ready to enable our staff to deal with your query quickly:

- Name of the product
- Model number as shown on the underside of the appliance
- Serial number



Your two-year guarantee

- It is important to retain the retailers receipt as proof of purchase. Staple your receipt to this back cover for future reference.

Please quote the following information if the product develops a fault. These numbers can be found on the base of the product.

Model no. Serial no.

All Goblin products are individually tested before leaving the factory. In the unlikely event of any appliance proving to be faulty within 28 days of purchase it should be returned to the place of purchase for it to be replaced.

If the fault develops after 28 days and within 24 months of original purchase, you should take the appliance to your nearest service agent. A list containing details of your nearest service agent is included with your appliance but please contact the helpline quoting model number and serial number should you require further assistance. Repair or replacement of the product is subject to the exclusions set out below (1-6).

If you suspect a fault, follow the simple checks detailed below before returning the appliance or calling the helpline.

- Check the dust bag and filters for blockages.
- Check the hose and tubes for blockages.
- Check the plug is firmly in the socket and the supply is switched on.
- Make sure the socket is working by trying another appliance.

If for any reason this item is replaced during the 2-year guarantee period, the guarantee on the new item will be calculated from original purchase date. Therefore it is vital to retain your original receipt or invoice to indicate the date of initial purchase.

To qualify for the two-year guarantee the appliance must have been used according to the manufacturers instructions. For example bags and filters should be changed or cleaned regularly.

Goblin shall not be liable to replace or repair the goods under the terms of the Guarantee where:

- 1 The fault has been caused or is attributable to accidental use, misuse, negligent use or used contrary to the manufacturers recommendations or where the fault has been caused by power surges or damage caused in transit.
- 2 The appliance has been used on a voltage supply other than that marked on the products.
- 3 Repairs have been attempted by persons other than our service staff (or authorised dealer).
- 4 Where the appliance has been used for hire purposes or non-domestic use.
- 5 The guarantee excludes consumables such as bags and filters.

This guarantee does not confer any rights other than those expressly set out above and does not cover any claims for consequential loss or damage. This guarantee is offered as an additional benefit and does not affect your statutory rights as a consumer.

- This guarantee is valid in the UK and Ireland only.

For additional information on Goblin products www.morphyrichards.co.uk

Goblin products are intended for household use only

Goblin has a policy of continuous improvement in product quality and design. The Company, therefore, reserves the right to change the specification of its models at any time.

Goblin

The After Sales Division,
Goblin, Mexborough,
South Yorkshire, England, S64 8AJ

Helpline (office hours)
UK 0870 060 2604
Republic of Ireland 1800 409119

8783370 Rev 2 8/02